



Flat 2, 318 High Street Rochester, Kent, ME1 1BT

Greenleaf are delighted to offer this second floor, two bedroom Flat to let within close proximity to Rochester Train Station. With open plan kitchen/lounge, two bedrooms and shower room. Gas central heating and available now.

In order to reserve a property you will be required to pay a holding deposit equivalent to one weeks rent. This will be refunded once checks are complete unless false or misleading information is provided, a Right to Rent check fails or you withdraw from the property. It can, with agreement be put towards the first months rent due along with the five week deposit. If you require any further information just give the team a call or email on info@greenleaf-property.co.uk.

Greenleaf are a member of the PRS (property redress scheme) membership number: PRS003992
Greenleaf Property Services Ltd have client money protection – property mark - membership – C0128543

£950 Per Month

Flat 2, 318 High Street

Rochester, Kent, ME1 1BT



- TWO BEDROOM FLAT
- GAS CENTRAL HEATING
- 5 WEEK DEPOSIT £1096.15 (RENT X12/52 X5)
- OPEN PLAN LOUNGE/ KITCHEN
- AVAILABLE NOW
- COUNCIL TAX BAND A
- WALKING DISTANCE TO RAILWAY AND ROCHESTER HIGH STREET
- 1 WEEK HOLDING DEPOSIT £219.23 (RENT X12/52)
- EPC BAND D



[Directions](#)

Tel: 01634730672



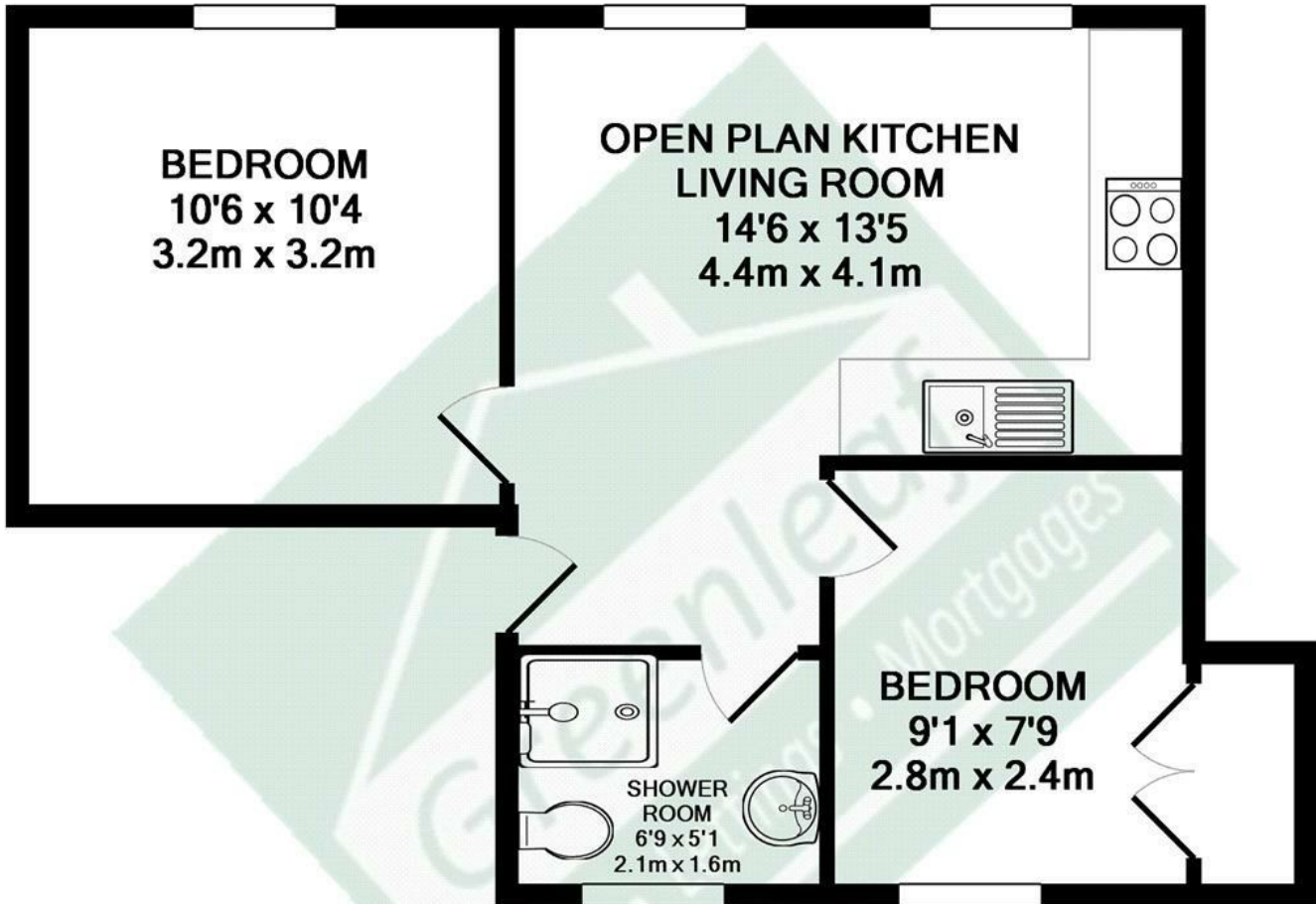

TOTAL APPROX. FLOOR AREA 390 SQ.FT. (36.2 SQ.M.)

Whilst every attempt has been made to ensure the accuracy of the floor plan contained here, measurements of doors, windows, rooms and any other items are approximate and no responsibility is taken for any error, omission, or mis-statement. This plan is for illustrative purposes only and should be used as such by any prospective purchaser. The services, systems and appliances shown have not been tested and no guarantee as to their operability or efficiency can be given

Made with Metropix ©2013

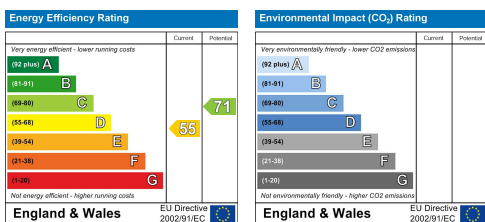

Greenleaf Property Services is a trading name of Greenleaf Property Services Limited.
 Registered Office: 281 Wilson Avenue, Rochester Kent ME1 2SS
 Registered No: 06222461 England. VAT No: 908929091

These particulars, whilst believed to be accurate are set out as a general outline only for guidance and do not constitute any part of an offer or contract. Intending purchasers should not rely on them as statements of representation of fact, but must satisfy themselves by inspection or otherwise as to their accuracy. No person in this firm's employment has the authority to make or give any representation or warranty in respect of the property.